



PO Box 9548, Huntington, WV 25704

## **GOLD STAR FAMILIES MEMORIAL MONUMENT**

Project Information, Design, and Schematics



# HERSHEL WOODY WILLIAMS MEDAL OF HONOR FOUNDATION

[www.hwwmohfoundation.org](http://www.hwwmohfoundation.org)



## **GOLD STAR FAMILY MEMORIAL MONUMENT**

America has many memorials and monuments giving honor to the patriots who have sacrificed and given their lives for our freedom, and paying tribute to those who have faithfully served in our Armed Forces since becoming a Nation.

There is one group of our citizens, the families of a loved one who gave their life to protect our freedom and to give freedom to many who have never experienced it. The sacrifices of those Gold Star families have never been given recognition and honor for their sacrifice and suffering to keep America free.

The Gold Star Families Memorial Monument honors those families who sacrificed more than most of us, and illustrates that America has citizens in every community and hamlet willing to make such sacrifices. The memorial monument further illustrates that families suffer and grieve when a dear relative is lost. Without their sacrifices, freedom could not and would not have been preserved.

This Gold Star Families Memorial Monument is appropriate in any community, Veterans Park, Memorial Park, City Park, or Veteran's Cemetery as a tribute to all the families who gave one of their own for all of us.

**Freedom Has Never Been Free**

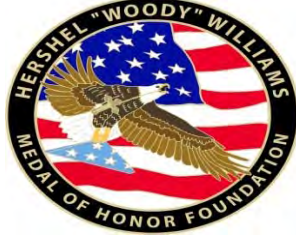

## **GOLD STAR FAMILY MEMORIAL MONUMENT**

### **INFORMATION**

**Additional Information can be found on our web-site:**

[www.hwwmohfoundation.org](http://www.hwwmohfoundation.org)

The material that the Gold Star Families Memorial Monument is constructed from may be black marble or black granite; however, research indicates that granite has a longer endurance than marble. The GSF Memorial Monument is not registered with any agency; and the original contractors/architects (Architect letter pg. 5) are happy to answer any question or address any concerns. It is suggested that a plaque (bronze or granite) (18" x 16" atop a 4" x 4" post) be placed near or adjacent to the GSF Memorial Monument giving an explanation of the message and meaning of the scenes of the monument to insure an understanding of each of the panels of the memorial monument. (See Verbiage on next page).

Information, design, and presentation drawings as well as a letter from the architect and planner are included in this package.

Many communities/cities have Honorary Board Members from our foundation and will be happy to assist anyone interested in this project.

Honorary Board Member, Medal of Honor Recipient Donald "Doc" Ballard has agreed to speak with anyone interested in using granite materials to build the GSF Memorial Monument. Mr. Ballard is in the monument business and has a couple of companies that supply his needs. Mr. Ballard's phone number is: 913-238-8405 and email is: colballardmoh@aol.com



### GOLD STAR FAMILY MEMORIAL MONUMENT EXPLANATION MARKER

#### GOLD STAR FAMILIES MEMORIAL MONUMENT

THE MONUMENT IS IN TRIBUTE TO AND HONORS THE FAMILIES WHO LOST ONE OR MORE LOVED ONES IN THE ARMED FORCES OF THE UNITED STATES

THE FIRST SCENE DEPICTS THEIR HOMELAND: THE UNITED STATES OF AMERICA

THE NEXT SCENE IS A FATHER AND MOTHER WITH A NEWBORN BABY: THE FAMILIES OF OUR FALLEN HEROES

THE NEXT SCENE INDICATES THE YOUTH OF AMERICA WHO VOLUNTEER TO SERVE AND PROTECT US AND GIVE OTHERS A FREEDOM THEY NEVER KNEW

THE CUT OUT OF THE MISSING PERSON REPRESENTS THE SACRIFICE OF LIFE FOR PEACE AND FREEDOM

THE LAST SCENE DEPICTS THE FAMILIES GRIEVING THE LOSS OF LOVED ONES WHO SACRIFICED THEIR LIVES TO PRESERVE OUR RIGHTS, LIBERTIES, AND THE AMERICAN FLAG UNDER WHICH THEY SERVED



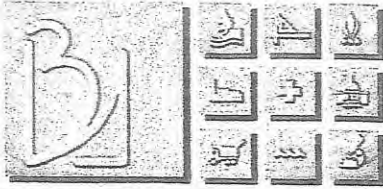

blackwood associates, inc.  
architects-planners

June 28, 2012

Mr. Hershel Williams  
3450 Wire Branch Road  
Ona, WV 25545-9513

Re: Gold Star Families Monument

Dear Mr. Williams

It would be an honor to have the Gold Star Families Monument erected at locations beyond the DKMSVC in Institute, WV.

The time invested in the design and the presentation drawings, including the color images and videos were never billed to anyone. I performed this work gratis in an effort to express my respect to you, my appreciation for the members of the U.S. military who dedicated themselves to protecting the country we love, and especially my gratitude to the families of fallen soldiers for the sacrifices they will forever endure, and to whom adequate honor can never be fully paid.

Blackwood Associates, Inc. has no desire to profit from the construction of this Monument. Please understand there were costs associated with the construction of the Monument that were part of the overall construction of the Cemetery in Institute, WV. Some costs will likely be required if the Monument is constructed at other locations. Mainly the foundation design: this could vary at other locations due to soil conditions and construction methods. We would strongly recommend that the soil conditions at prospective Monument sites, and the adequacy of the foundation system, be reviewed and approved by a qualified geotechnical engineer. (The granite slabs and base are nearly 4 tons! We don't want it to sink or settle unevenly.) Another important consideration for the Monument is the orientation, relative to the sun.

Regarding the images used for the laser etchings, specifically the iconic photograph of the Marines Raising the Flag on Iwo Jima taken by Joe Rosenthal / The Associated Press. I have done some research but not been able to determine if written permission is required for using the photo as a *reference* for artwork. We are not re-printing the photo nor using it for profit. This image has been used on many WWII and Marine Monuments around the country. I'm not sure if you have any insight regarding this.

I give you, Hershel Williams, permission to use the Gold Star Families Monument design, originally intended to be constructed at the Donel C. Kinnard Memorial State Veterans Cemetery in Institute, West Virginia, for construction at other locations, with the following caveats:

1. I, Kenton Blackwood, be recognized as the designer of the Monument, and for the following inscription be placed in small letters in a non-descript location of the monument: "Designed by Blackwood Associates, Inc." (example attached)
2. I, Kenton Blackwood, and Blackwood Associates, Inc. of Fairmont, West Virginia shall be held harmless and free of any liability for the design and construction.

I hope this suffices as an expression of permission to use the design! Within the next few weeks we will put together a set of generic construction drawings for you to distribute and use at your discretion (without the DKMSVC references!) Please keep us informed as to the progress. It would mean a great deal to me and my family to be invited to any dedications for the Monument. Do not hesitate to contact me with any questions or if I can be of further assistance to this endeavor.

Sincerely,  
BLACKWOOD ASSOCIATES, INC.  
ARCHITECTS AND PLANNERS

KENTON Q. BLACKWOOD, VP, LEED AP Assoc. AIA

Enclosure  
Copy: Keith Gwinn - Cabinet Secretary, West Virginia Department of Veterans Assistance

611 east park avenue - fairmont, wv 26554 phone 304-366-1580 - fax 304-366-1537  
e-mail: [kenton@wvarchitects.com](mailto:kenton@wvarchitects.com) <http://www.wvarchitects.com>

GRANITE MONUMENT W/  
CONCRETE WALK, BASE &  
FOUNDATION

20'-0"

10'-0"

SIDEWALK -  
VERIFY  
EXISTING  
CONDITIONS



SUGGESTED  
ORIENTATION

R10'-0"

R3'-4"

J  
E

J  
E

J  
E

J  
E

J  
E

**GOLD STAR FAMILIES MEMORIAL MONUMENT**  
HERSHEL "WOODY" WILLIAMS MEDAL OF HONOR FOUNDATION  
[WWW.HWWWMOHFOUNDATION.ORG](http://WWW.HWWWMOHFOUNDATION.ORG)

PLAN



1

© 2014 Blackwood Associates, Inc.



**blackwood associates inc.**  
[www.wvarchitects.com](http://www.wvarchitects.com)

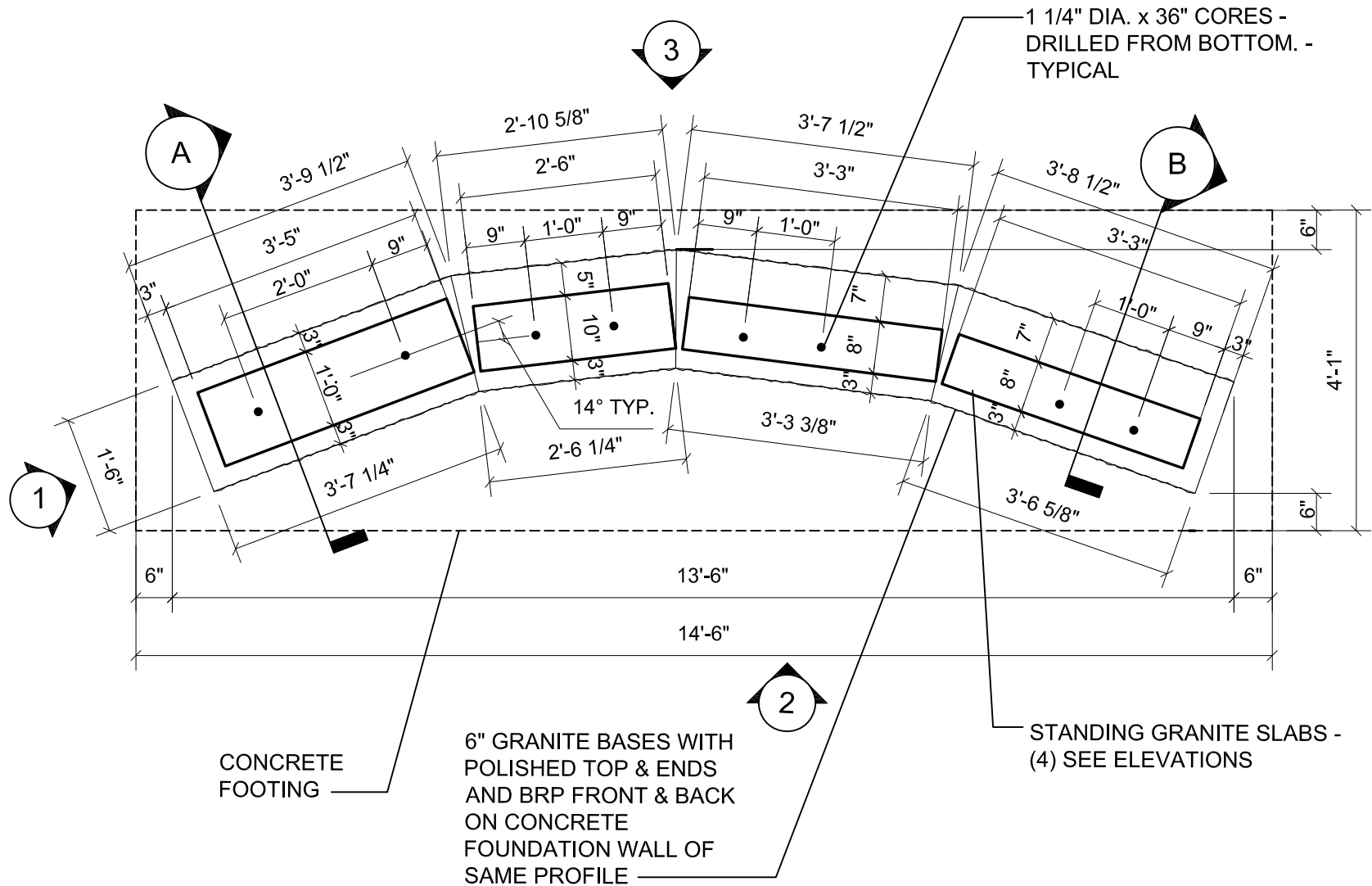

CONCRETE FOOTING

6" GRANITE BASES WITH POLISHED TOP & ENDS AND BRP FRONT & BACK ON CONCRETE FOUNDATION WALL OF SAME PROFILE

STANDING GRANITE SLABS - (4) SEE ELEVATIONS

**GOLD STAR FAMILIES MEMORIAL MONUMENT**  
 HERSHEL "WOODY" WILLIAMS MEDAL OF HONOR FOUNDATION  
 WWW.HWWMOHFOUNDATION.ORG

**ENLARGED PLAN**

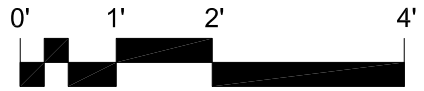

②

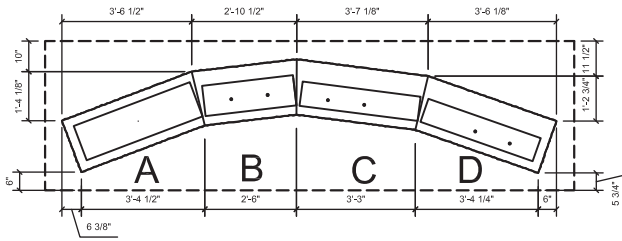

○ KEY PLAN  
NTS

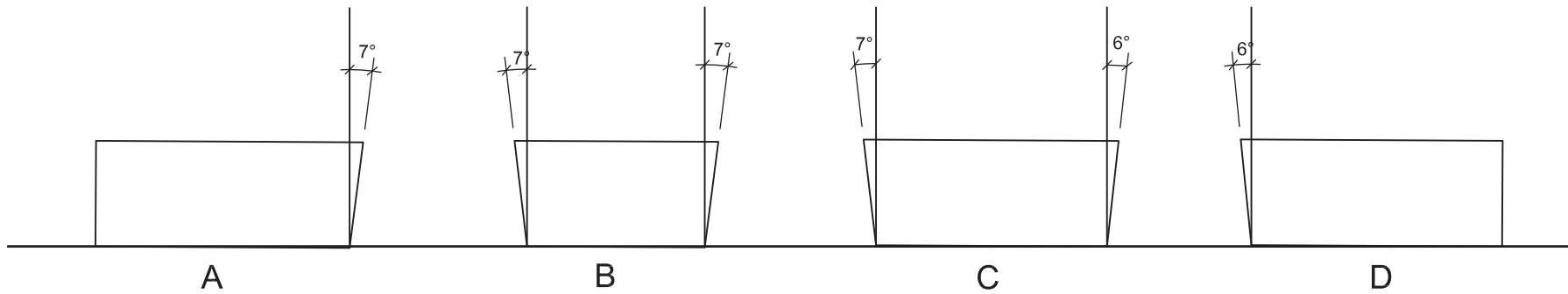

**GOLD STAR FAMILIES MEMORIAL MONUMENT**  
 HERSHEL "WOODY" WILLIAMS MEDAL OF HONOR FOUNDATION  
 WWW.HVMMOHFOUNDATION.ORG

 **blackwood associates inc.**  
 www.wvarchitects.com

# SUPPLEMENTAL BASE INFO



2A



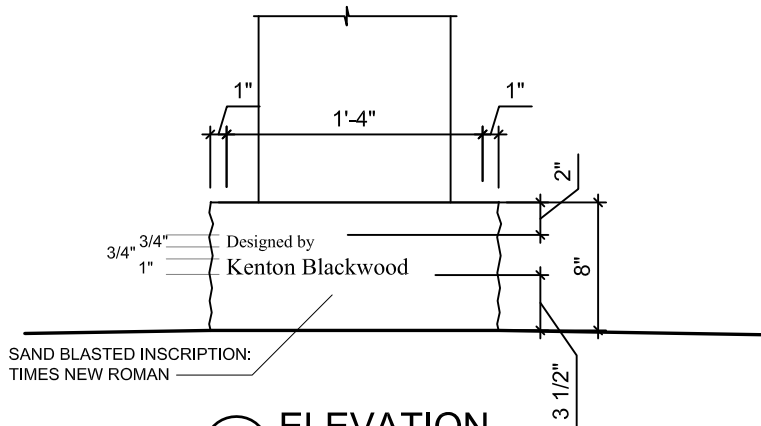

1A ELEVATION

STANDING GRANITE SLABS WITH  
LASER ETCHED ARTWORK AND  
SAND BLASTED INSCRIPTIONS:  
ENGRAVRSROMAN BT

MISSING SOLDIER  
CUT-OUT

ARTWORK PROVIDED  
IN SEPERATE FILE

PAINTED US FLAG  
RED, WHITE & BLUE  
AS APPLICABLE

TO RECOGNIZE THE SACRIFICES  
MADE BY FAMILIES WHO GAVE  
THEIR SONS OR DAUGHTERS  
FOR THE FREEDOM OF AMERICA

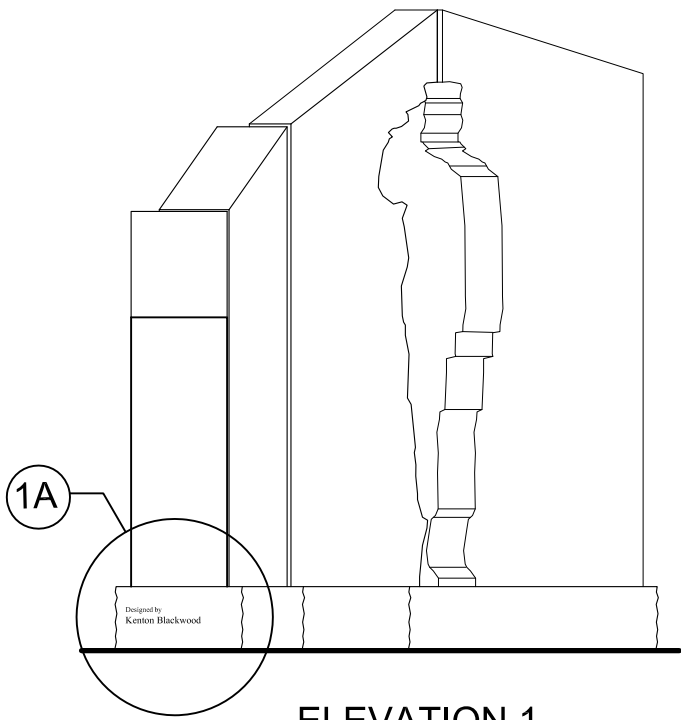

ELEVATION 1

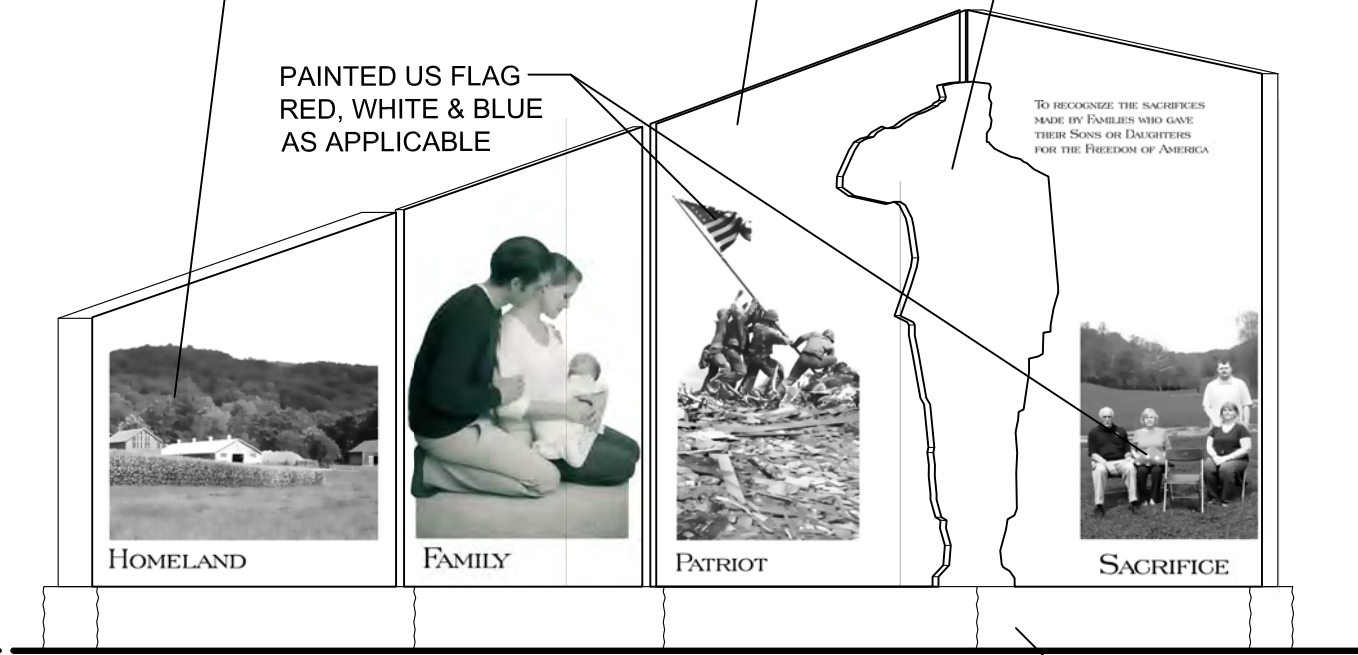

ELEVATION 2

GRANITE  
BASES

**GOLD STAR FAMILIES MEMORIAL MONUMENT**  
HERSHEL "WOODY" WILLIAMS MEDAL OF HONOR FOUNDATION  
WWW.HWWWMOHFOUNDATION.ORG

**ELEVATIONS**

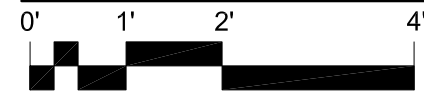

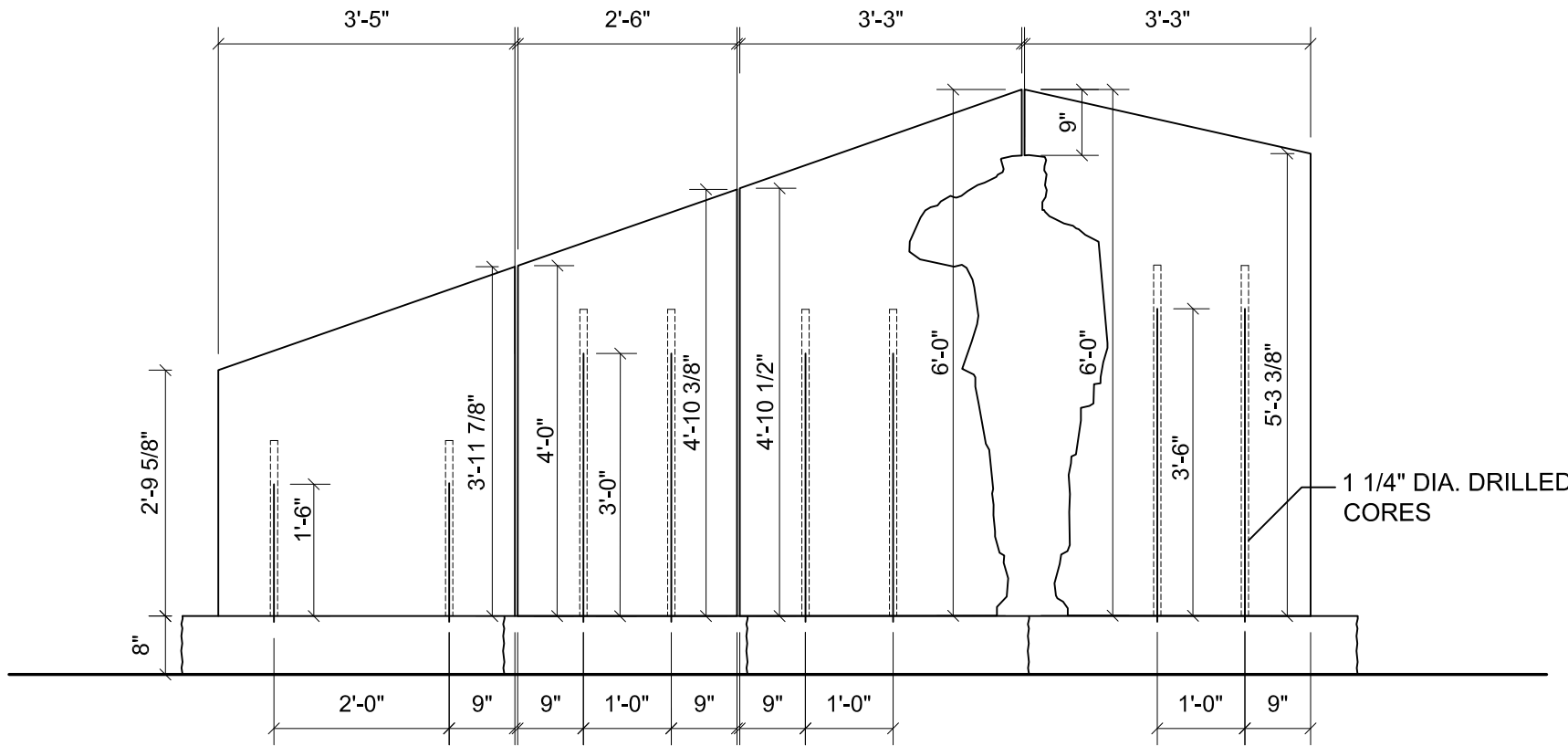

ELEVATION 2

**GOLD STAR FAMILIES MEMORIAL MONUMENT**  
**HERSHEL "WOODY" WILLIAMS MEDAL OF HONOR FOUNDATION**  
 WWW.HWWWMOHFOUNDATION.ORG

**ELEVATION**

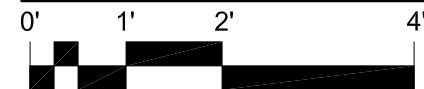

CAST BRONZE NAUTICAL STAR AND LETTERING  
(TIMES NEW ROMAN) WITH CONCEALED  
STAINLESS STEEL FASTENERS

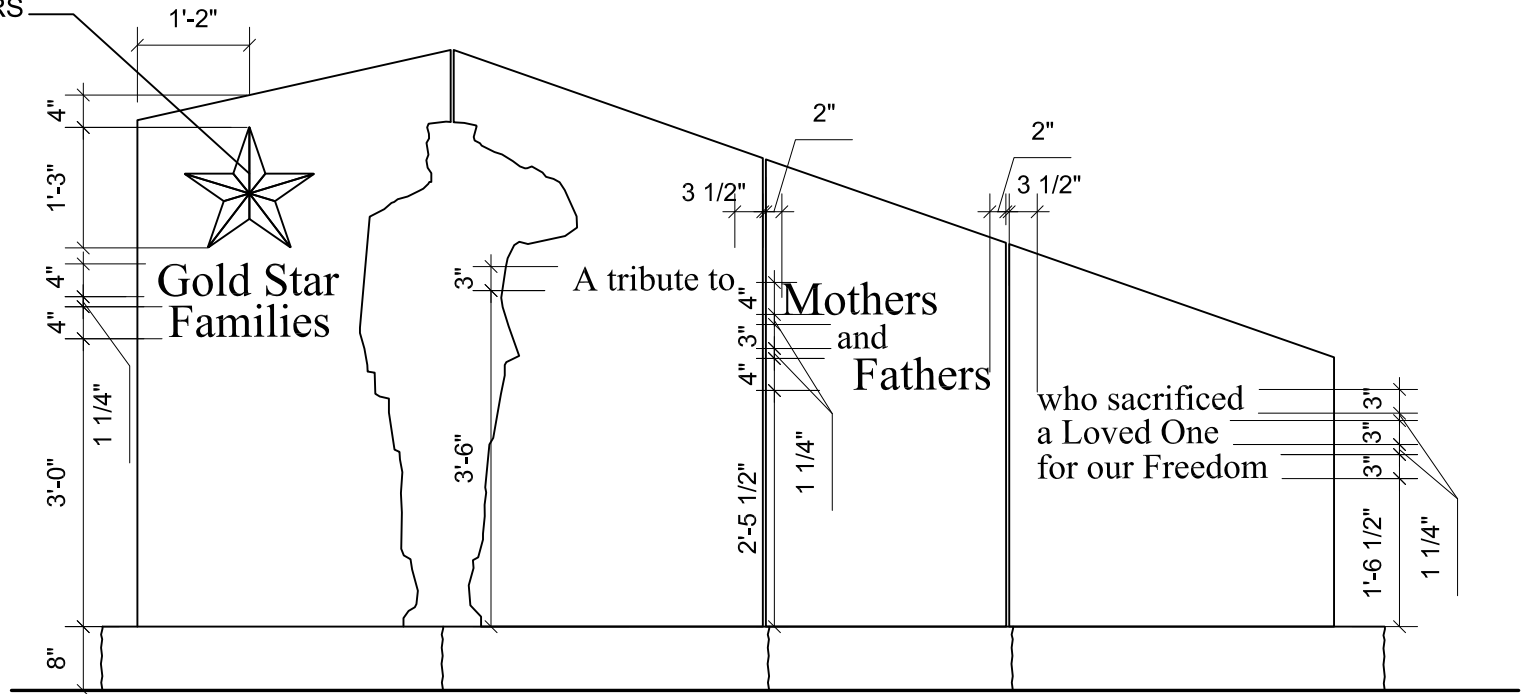

ELEVATION 3

**GOLD STAR FAMILIES MEMORIAL MONUMENT**  
HERSHEL "WOODY" WILLIAMS MEDAL OF HONOR FOUNDATION  
[WWW.HWWWMOHFOUNDATION.ORG](http://WWW.HWWWMOHFOUNDATION.ORG)

**ELEVATION**

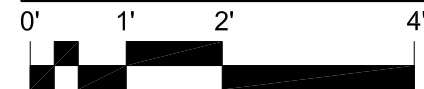

## KEY NOTES

1. 8" STANDING GRANITE SLAB, ALL POLISHED, ANGLED TOP, WITH SOLDIER CUT-OUT
2. 12" STANDING GRANITE SLAB, ALL POLISHED, WITH ANGLED TOP
3. 8" GRANITE BASE, POLISHED TOP AND ENDS, BRP FRONT AND BACK EDGES
4. REINFORCED CONCRETE FOUNDATION (4000 PSI) WITH DEAD FLAT TOP SURFACE, SMOOTH AND CLEAN TO ACCEPT GRANITE. (FOUNDATIONS ARE DESIGNED WITH AN ASSUMED MAXIMUM ALLOWABLE SOIL BEARING PRESSURE OF 2000 PSF NET. PROVIDE #4 REBARS CONTINUOUS AND @ 12" O.C. - TYPICAL PRIOR TO CONCRETE PLACEMENT, THE BEARING CAPACITY OF THE SOIL SHALL BE INSPECTED & APPROVED BY THE PROJECT GEOTECHNICAL ENGINEER.)
5. 4" CONCRETE SIDEWALK (4000 PSI) WITH LIGHT BROOM FINISH OVER 6 MIL VAPOR BARRIER ON #57 STONE BASE OVER GEO-TEXTILE STABILIZATION FABRIC AND COMPACTED SUBGRADE, 6X6 - W2.1XW2.1 WWF, CUT TO FIT ALONG RADIAL EDGE (TYP.) - MESH MUST BE HELD UP W/ CHAIRS. HOLD WWF 2" FROM TOP. SLOPE AWAY FROM MONUMENT.
6. 1 1/4" DIA. DRILLED CORES
7. #7 BARS AT FOUNDATION THRU DRILLED CORES.
8. 1/2" EXPANSION JOINT - BOND BREAKER MATERIAL W/ CAULK, CONTINUOUS, COLORED TO MATCH CONCRETE - TYPICAL AT EACH SIDE.

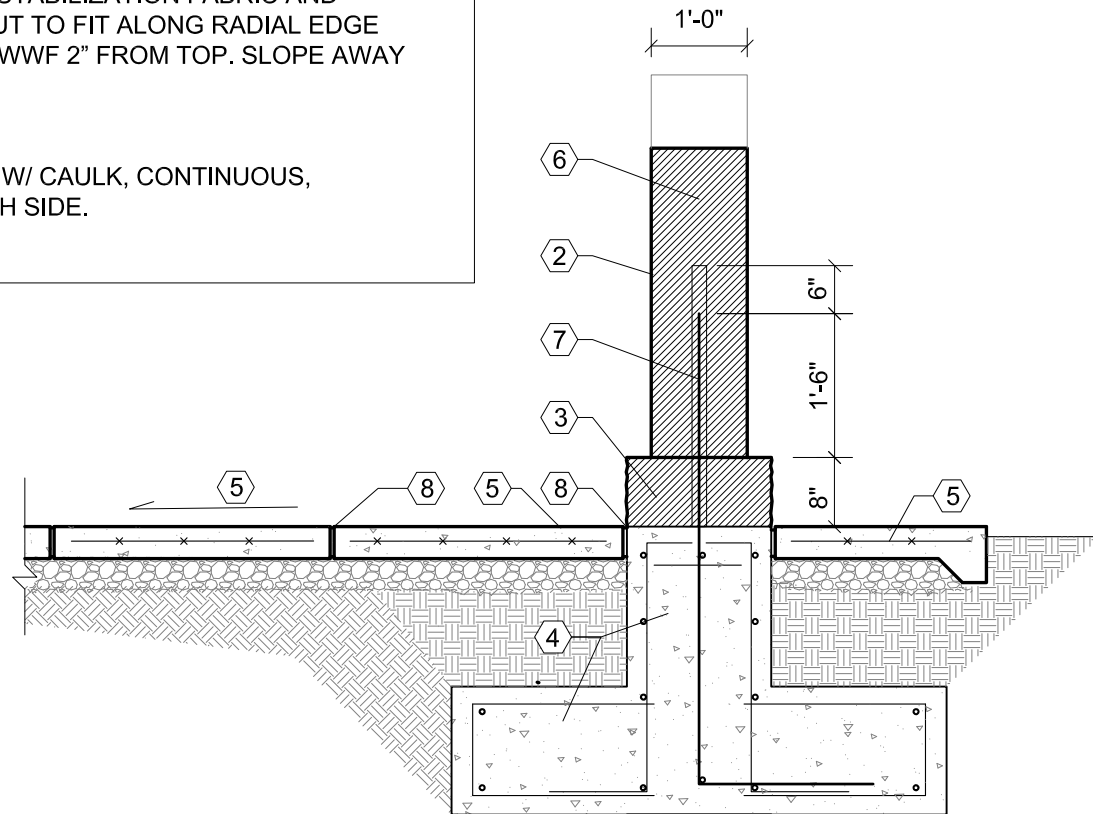

## GOLD STAR FAMILIES MEMORIAL MONUMENT

HERSHEL "WOODY" WILLIAMS MEDAL OF HONOR FOUNDATION

WWW.HWWMOHFOUNDATION.ORG

## SECTION A

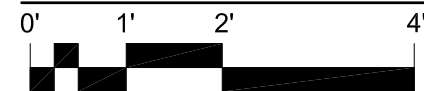

⑥



## KEY NOTES

1. 8" STANDING GRANITE SLAB, ALL POLISHED, ANGLED TOP, WITH SOLDIER CUT-OUT
2. 12" STANDING GRANITE SLAB, ALL POLISHED, WITH ANGLED TOP
3. 8" GRANITE BASE, POLISHED TOP AND ENDS, BRP FRONT AND BACK EDGES
4. REINFORCED CONCRETE FOUNDATION (4000 PSI) WITH DEAD FLAT TOP SURFACE, SMOOTH AND CLEAN TO ACCEPT GRANITE. (FOUNDATIONS ARE DESIGNED WITH AN ASSUMED MAXIMUM ALLOWABLE SOIL BEARING PRESSURE OF 2000 PSF NET. PROVIDE #4 REBARS CONTINUOUS AND @ 12" O.C. - TYPICAL PRIOR TO CONCRETE PLACEMENT, THE BEARING CAPACITY OF THE SOIL SHALL BE INSPECTED & APPROVED BY THE PROJECT GEOTECHNICAL ENGINEER.)
5. 4" CONCRETE SIDEWALK (4000 PSI) WITH LIGHT BROOM FINISH OVER 6 MIL VAPOR BARRIER ON #57 STONE BASE OVER GEO-TEXTILE STABILIZATION FABRIC AND COMPACTED SUBGRADE, 6X6 - W2.1XW2.1 WWF, CUT TO FIT ALONG RADIAL EDGE (TYP.) - MESH MUST BE HELD UP W/ CHAIRS. HOLD WWF 2" FROM TOP. SLOPE AWAY FROM MONUMENT.
6. 1 1/4" DIA. DRILLED CORES
7. #7 BARS AT FOUNDATION THRU DRILLED CORES.
8. 1/2" EXPANSION JOINT - BOND BREAKER MATERIAL W/ CAULK, CONTINUOUS, COLORED TO MATCH CONCRETE - TYPICAL AT EACH SIDE.

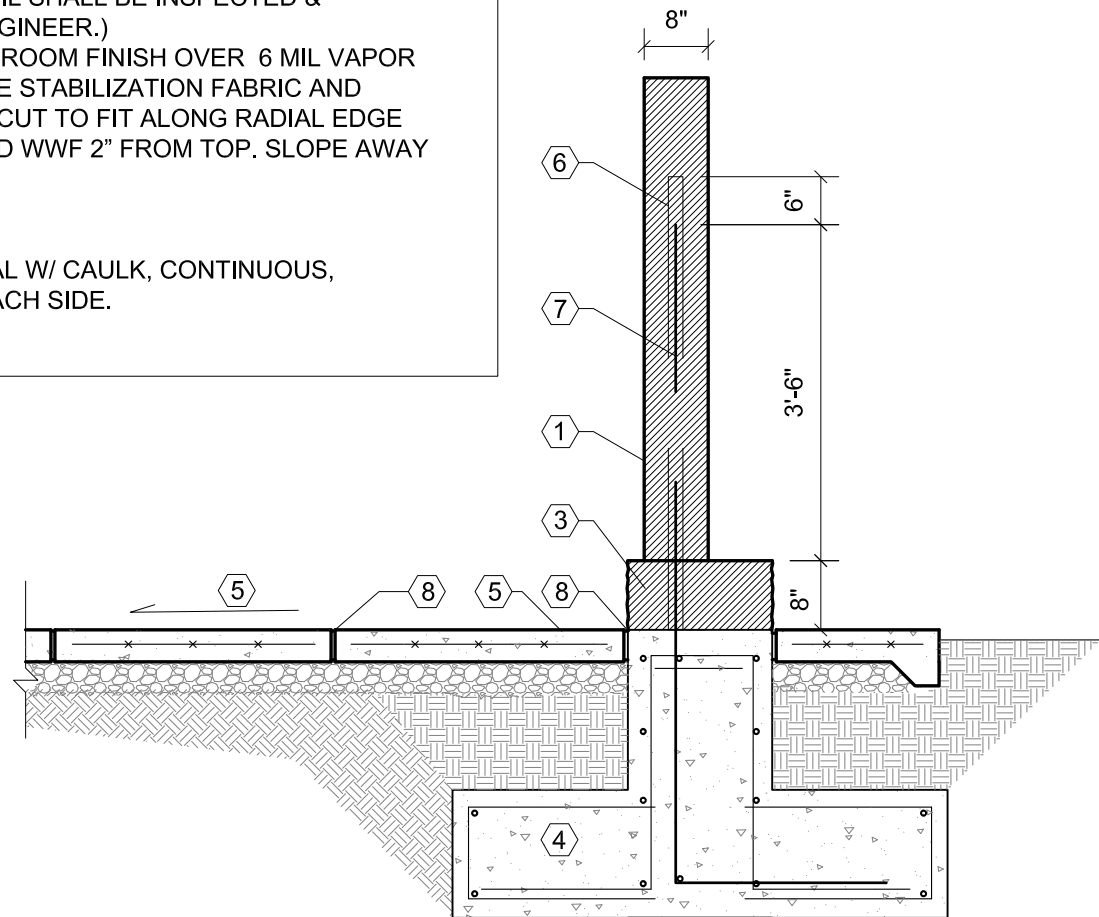

## GOLD STAR FAMILIES MEMORIAL MONUMENT

HERSHEL "WOODY" WILLIAMS MEDAL OF HONOR FOUNDATION

WWW.HWWWMOHFOUNDATION.ORG

## SECTION B

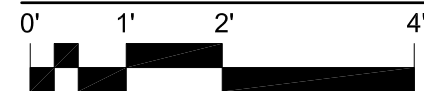

7

